

Service Bulletin

Fuel Systems

Bulletin No.: RS-72

Date: 11/15/80

Revised:

Subject: FUEL INJECTOR, MODEL RS-10ED1, PARTS LIST 391821-3 TO -4, PARTS LIST 2524031-2 TO -3 AND PARTS LIST 2524470-2 TO -3, MODIFICATION OF.

1. PLANNING INFORMATION:

A. EFFECTIVITY:

<u>Model Number</u>	<u>Parts List Number</u>
RS-10ED1	391821-3
RS-10ED1	2524031-2
RS-10ED1	2524470-2

B. REASON:

To provide detailed instructions for the modification of the Model RS-10ED1 Fuel Injectors listed above to incorporate the new seat and ball valve assembly.

C. DESCRIPTION:

Replace the existing seat and valve assembly with the new seat and ball valve assembly.

D. COMPLIANCE:

Operating Activities: Information only.

Overhaul Activities: Comply at overhaul.

E. APPROVAL: None.

F. MANPOWER:

Approximately 0.5 additional man-hours required at overhaul.

G. MATERIAL AVAILABILTIY:

<u>Part No.</u>	<u>Qty.</u>	<u>Nomenclature</u>	<u>Availability</u>
364868	1	Nut	Bendix Products Support Centers
364447	1	Washer	Bendix Products Support Centers

1. PLANNING INFORMATION: (Continued)

<u>Part No.</u>	<u>Qty.</u>	<u>Nomenclature</u>	<u>Availability</u>
383442	2	Cup	Bendix Products Support Centers
367759	1	Diaphragm	Bendix Products Support Centers
or			
2540880			Bendix Products Support Centers
2525223	1	Valve	Bendix Products Support Centers
2525221	1	Seat	Bendix Products Support Centers

NOTE: Diaphragm P/N 367759 is not stocked. Diaphragm P/N 2540880 will become available approximately 4/81. Contact Bendix Products Support Centers upon ordering to confirm part availability.

Until diaphragm P/N 2540880 becomes available, diaphragm 367759 can be obtained by disassembly of (new) diaphragm assembly P/N 367758.

H. TOOLING:

Locally manufactured.

I. WEIGHT AND BALANCE:

Not affected.

J. REFERENCES:

None.

K. PUBLICATIONS AFFECTED:

Overhaul Manual and Illustrated Parts List, Model RS-10ED1. Bendix Form 15-362C.

2. ACCOMPLISHMENT INSTRUCTIONS:

A. During the course of overhaul of the Parts List Numbers 391821-3, 2524031-2, and 2524470-2 Fuel Injectors, proceed as follows: (Refer to figure 4-1 of the affected publication).

(1) Locally fabricate a puller and remove the part number 367648 seat from the cover assembly (93).

(2) Apply Loctite Hydraulic Sealant sparingly to the OD of the new P/N 2525221 seat.

NOTE: Loctite products are procurable from Loctite Corporation, 705 North Mountain Road, Newington, Connecticut 06111.

(3) Press the part number 2525221 seat into the cover (97) with an arbor press to the dimension indicated in figure 1 of this directive. Wipe excess sealant from the bushing and cover, with MEK or acetone.

2. ACCOMPLISHMENT INSTRUCTIONS: (Continued)

- (4) Assemble together parts (1 through 6, figure 2) of this directive and tighten nut (1) to a torque value of 5-7 inch-pounds. Retorque to original value after 20 minutes. Retorque only once.
- (5) Reassemble the Fuel Injector as outlined in the affected publication except discard the spring (95) and valve assembly (94) and install the parts assembled in preceding step (4) in place of the diaphragm assembly (98).
- (6) Functionally test the RS-10ED1 Fuel Injector as outlined in the affected publication.

B. IDENTIFICATION:

- (1) If the identification plate is reused, it is permissible to overstrike the Parts List number, less any issue changes not incorporated during this and/or previous overhauls.
- (2) If new plate is used, reidentify as follows:
 - (a) Transfer the exact model number from the old identification plate.
 - (b) Reidentify the unit with new applicable Parts List number, less any issue changes not incorporated during this and/or previous overhauls.

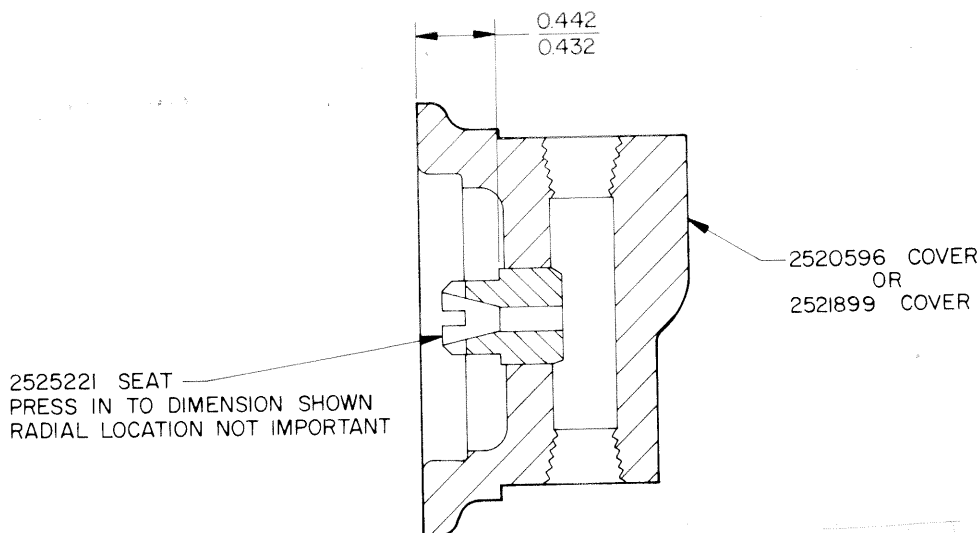

Figure 1.

2. ACCOMPLISHMENT INSTRUCTIONS: (Continued)

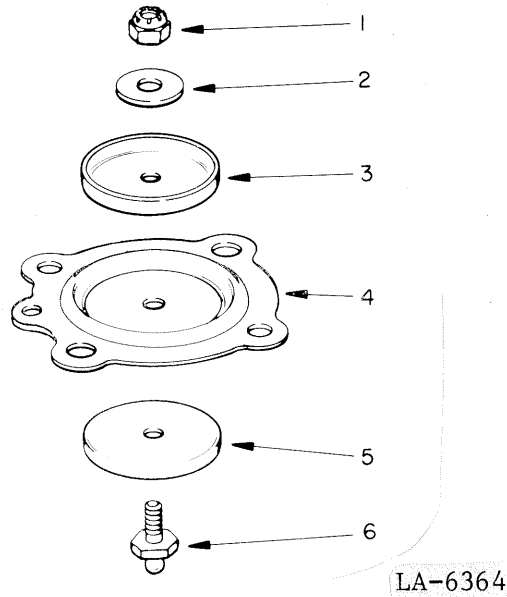

Figure 2.

(c) I.C. this block should be left blank.

(d) Transfer the exact serial number from the old identification plate.

Old P/L and Issue No.

391821-3
2524031-2
2524470-2

New P/L and Issue No.

391821-4
2524031-3
2524470-3

3. MATERIAL INFORMATION:

<u>New P/N</u>	<u>Qty.</u>	<u>Nomenclature</u>	<u>Old P/N</u>	<u>Disposition</u>
364868	1	Nut		
364447	1	Washer		
383442	2	Cup		
367759	1	Diaphragm	367758 (Assy.)	Scrap
or				
2540880				
2525223	1	Valve		
2525221	1	Seat	367648	Scrap
	1	Valve Assembly	367632	Scrap
	1	Spring	367640	Scrap
2539342 } or 2539343 }	1	Cover Assembly	2521900 } or 2520597 }	Rework

K. R. Dettweiler
K. R. Dettweiler
Manager of Service